

- LEGEND**
- NEW CONCRETE SIDEWALK
 - RESTORATION AREA (100mm TOPSOIL AND SOD)
 - DETECTABLE WARNING INDICATORS (REFER TO TYPICAL DETAILS)
 - TREE PROTECTION BARRIER
 - DROP CURB

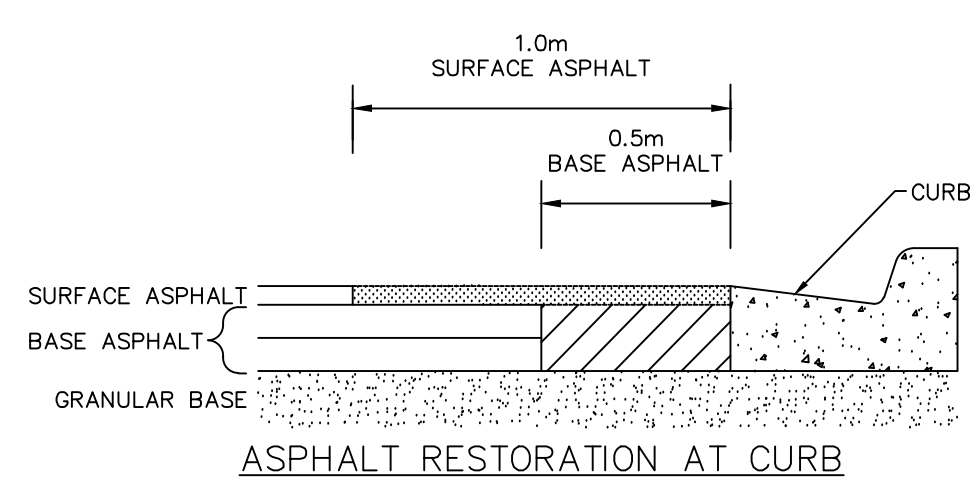
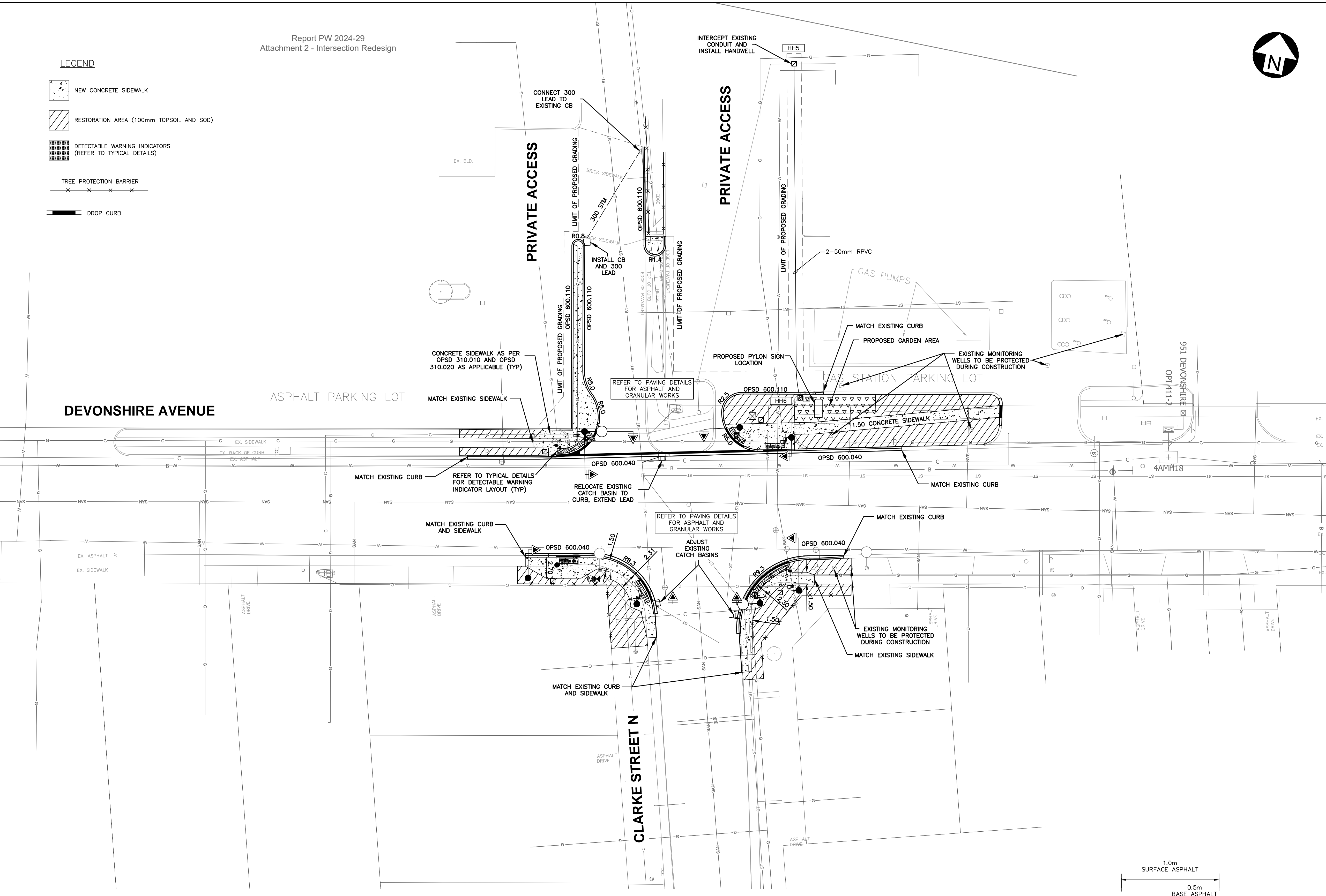

- CONTRACTOR'S NOTES:**
1. ALL DIMENSIONS ARE IN METRES AND/OR MILLIMETRES UNLESS OTHERWISE INDICATED.
 2. DRAWINGS ARE NOT TO BE SCALED.
 3. THE CONTRACTOR SHALL VERIFY ALL DIMENSIONS IN FIELD AND SHALL REPORT ANY DISCREPANCIES TO THE ENGINEER IMMEDIATELY UPON FINDING.
 4. THE EXACT LOCATION OF UTILITIES SHALL BE DETERMINED BY CONSULTING THE UTILITY COMPANIES CONCERNED. THE CONTRACTOR SHALL PROVE THE LOCATION OF UTILITIES EXISTING TRAFFIC SIGNAL SHALL REMAIN OPERATIONAL UNTIL THE NEW EQUIPMENT IS ENERGIZED AND OPERATIONAL. PAID-DUTY POLICE SHALL BE UTILIZED FOR ANY PLANNED SERVICE OUTAGES.
 5. ALL PAVEMENT MARKINGS SHALL BE IN ACCORDANCE WITH ONTARIO TRAFFIC MANUAL BOOK 11.

AREA MUNICIPALITY: 
Woodstock
ONTARIO • CANADA

CONSULTANT: 
RVA
R.V. ANDERSON ASSOCIATES LIMITED

RVA PROJECT NO. 215926

REVISION		
#	DESCRIPTION	DATE
3	ISSUED FOR 100% REVIEW	2024-05-29
2	ISSUED FOR 90% REVIEW	2024-05-21
1	ISSUED FOR 60% REVIEW	2024-05-08
#	DESCRIPTION	DDMMYYYY BY
DESIGNED BY: J.M.G.	DRAWN BY: J.M.G.	APPROVED BY: M.A.W.

**DEVONSHIRE AVENUE AT CLARKE STREET NORTH
NEW CIVIL CONSTRUCTION**

CONTRACT #: 930300-2024A
PROJECT NAME: TRAFFIC SIGNAL INSTALLATION
DEVONSHIRE AVE. & CLARKE ST. N.
LOCATION: CITY OF WOODSTOCK

SCALE: HOR. 1:250
VER. 1:50

DRAWING #: **C03**